

# Ambassador SERIES



Providing the widest selection of quality vinyl and aluminum window & door products.

*International Window*  
**IWVC**  
Your Window to the World®

# Ambassador 8200 SERIES

The Ambassador Series, which features our innovative Isobar ThermoTech™ design, is a high-performance aluminum window that is energy efficient as well as meets the color requirements of an interior designer. With its dual design extrusions, you can mix earth tones on the outside with neutral colors on the inside. When energy efficiency is a priority or requirement, the Ambassador Series can meet these demands.



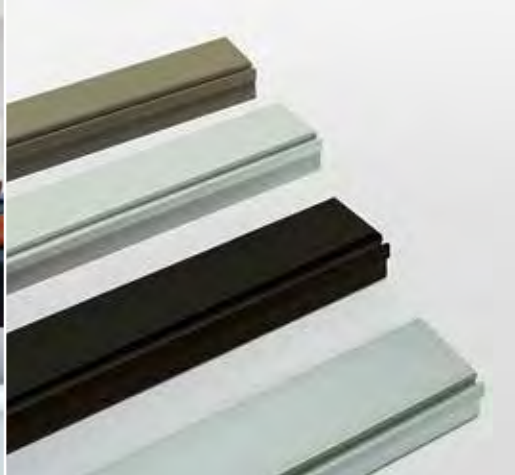

## Dual Color Options: Our ThermoTech process enables you to match to both exterior & interior color schemes

*J = Mojave Beige*

*W = White Paint*

*P = Bronze Anodized*

*A = Clear Anodized*

*\*For Dual Color options, specify exterior / interior finish ( i.e. J / W )*

## IMPORTANT POINTS AND KEY FEATURES

### • Frame Options:

*1-3/8" Nail-On Frame*

*Block Frame*

*Retro-Fit Frame*

### • 2-3/4" Frame Depth

### • State of the art Isobar ThermoTech Extrusions

*Nail-On and Block Frames are 1/2" under callout size. Retro-Fit Frame is net frame dimension.*

### • Double Fin-seal Weatherstripping on full Perimeter of Vent

### • Notched Corners for added strength and durability

### • Anti-lift sash blocks

### • Weephole Covers

### • Clean Design and Even Sight Line

### • Lifetime Warranty

## ThermoTech™ Extrusions - Fully thermally broken to achieve maximum energy performance



### New innovative windows from International Window

Tired of looking at dark frames against your white walls? Can't achieve that Southwestern look on your home's exterior with white frames? Look no further. The Dual Design of the Isobar ThermoTech™ extrusions allows you to achieve the designer look you desire.

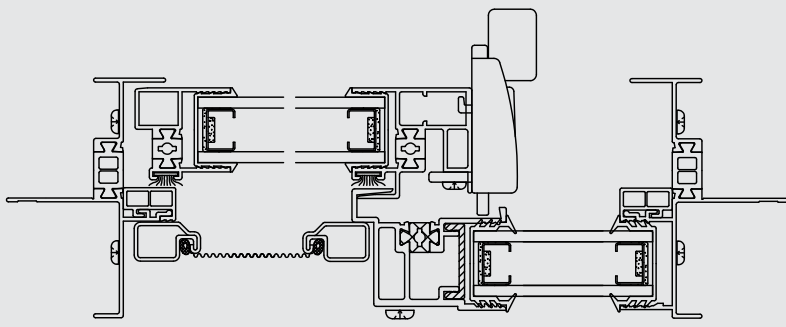

Horizontal Detail

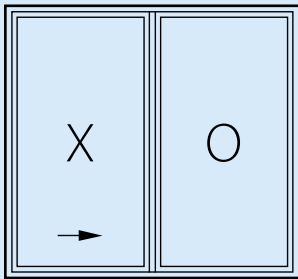

XO

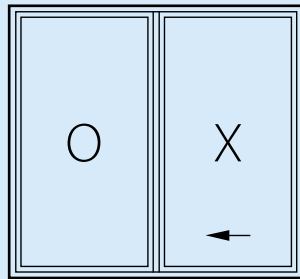

OX

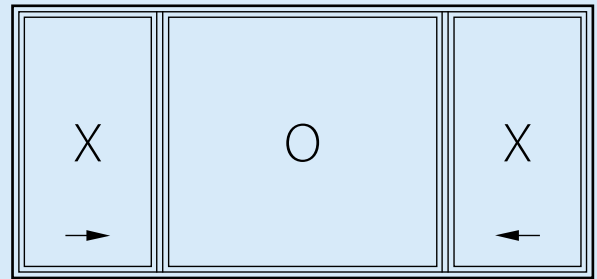

XOX

## Horizontal Sliding Window

### HORIZONTAL SLIDING FEATURES



#### Vent Stop

Provides Ventilation



#### Adjustable Delrin Rollers

Smooth Operation



#### Weep Hole Covers

Reduces wind & debris

- *3/4" Dual Glazing*
- *2-3/4" Frame Depth*
- *Retro-Fit Frame Available*

- *Clean Design and Even Sight Line*
- *Anti-Lift Sash Blocks*
- *Handed Latches - locked in "down" position*



## Casement Configurations

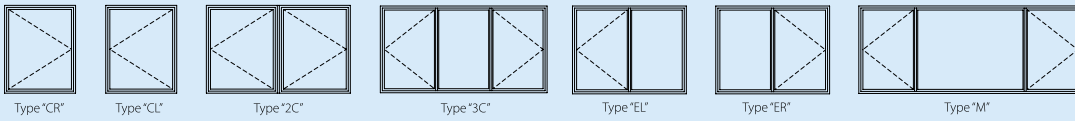

## Awning Configuration

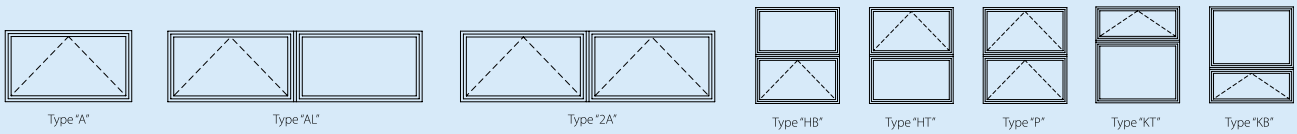

# Casement & Awning Window



**Full-Flip Folding Handle**

- *1" Dual Glazing*
- *2-3/4" Frame Depth*
- *Butt Hinges-Allows for larger sizes*
- *Features a standard folding handle*
- *Aluminum Extruded Screen*
- *Retro-Fit Frame Available*

### Casement Detail

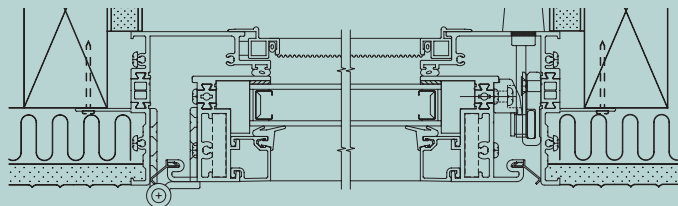



Single Hung Detail

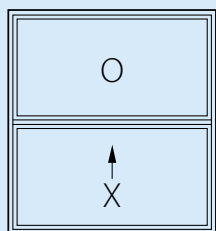

1/1 Single Hung

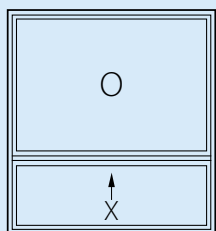

1/3 Vent

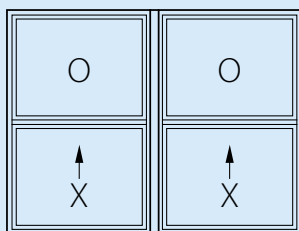

Twin 1/1 by 1/1

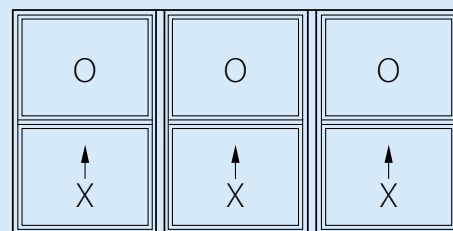

Triple 1/1 by 1/1 by 1/1

# Single Hung Window

## SINGLE HUNG FEATURES



**Tilt-in Sash**



**Cam Latch**

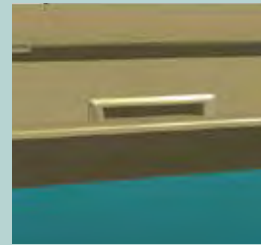

**Sloped Sill w/ Weep Hole Cover**

- *3/4" Dual Glazing*
- *Clean Design and Even Sight Line*
- *Retro-Fit Frame Available*

- *Block & Tackle Balancers*
- *Tilt in sash for ease of cleaning*

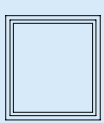

Square or Rectangle



Round

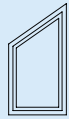

Rake



Quarter Rounds

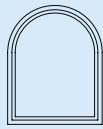

Extended Half Round

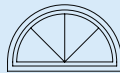

Half Round

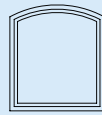

Extended Eyebrow



Right & Left Eyebrow

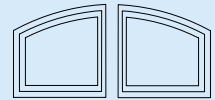

Right & Left Extended Eyebrow

## Picture Window & Special Shapes

- *1" Dual Glazing*
- *Clean Sightlines*
- *Meets Light Commercial ratings*
- *Exterior Aluminum Extruded Stops*

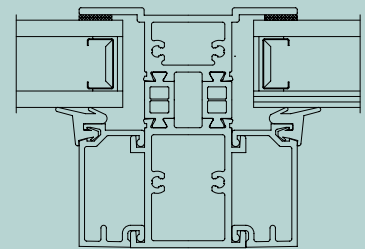
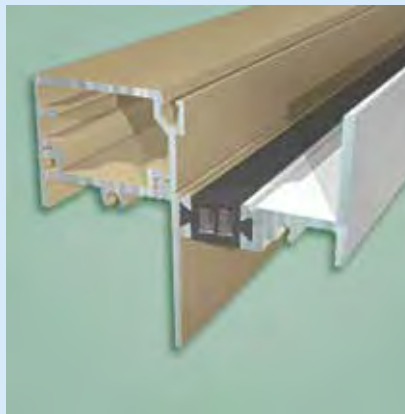

Integral Mullion detail to create multiple lite picture windows

### Picture Window Detail

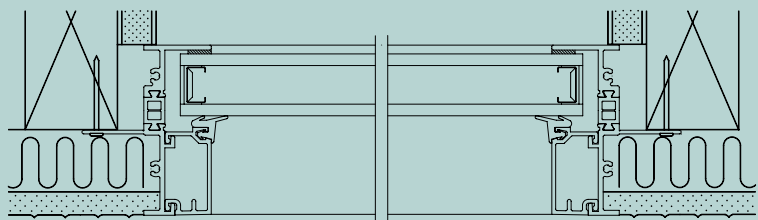





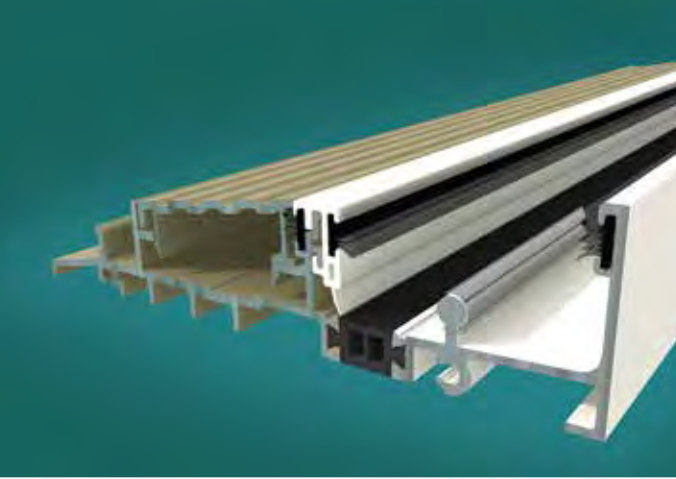

## Sliding Door Detail

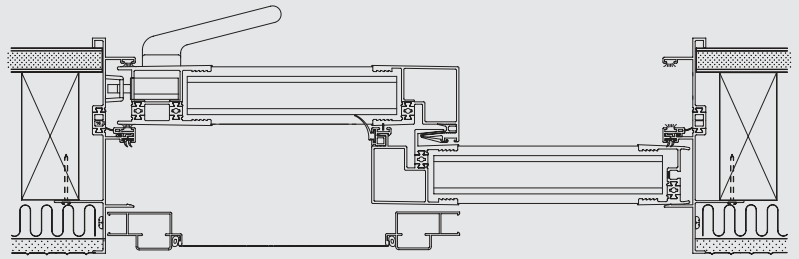

2 PANEL DOORS

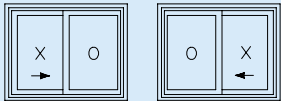

XO

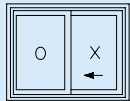

OX

3 PANEL DOORS

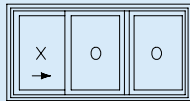

XOO

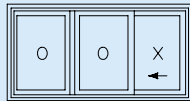

OOX

4 PANEL DOORS

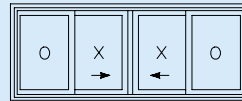

OXXO

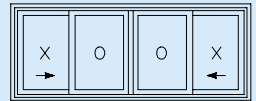

XOOX

## 8900 Ambassador Sliding Glass Door

- Std 1-13/16" Dia Sealed Ball Bearing rollers
- Optional stainless Steel Rollers
- Handle Hardware available in 4 finishes - Black, Silver, White and Mojave Beige
- Dual Finish Available
- 1" Dual Glazing
- Optional Key Lock
- Retro-Fit Frame Available



### Attractive "C" Handle

All doors include a mortise recessed lock system with an ergonomically designed "C" handle. This lock has been tested to CAWM's rigorous security standard that meets or exceeds all local jurisdictions.

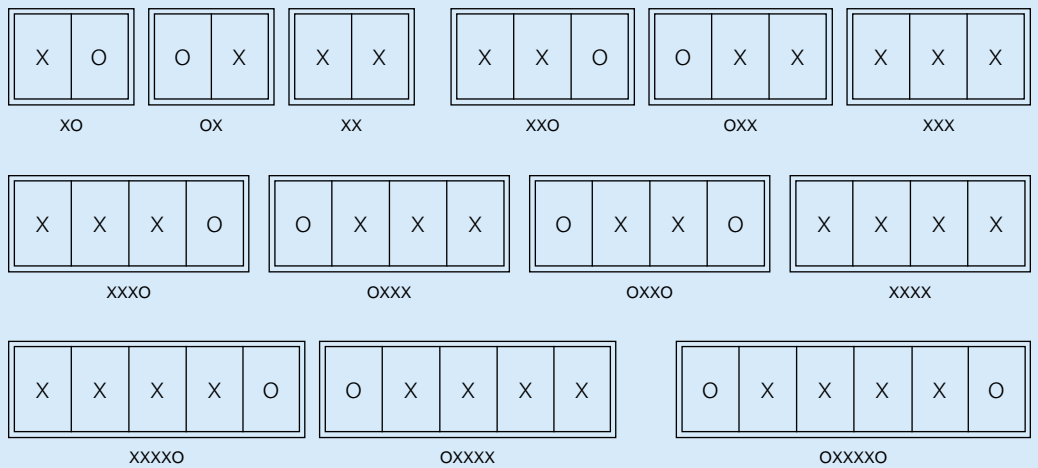



Quad Roller and Flush Handle are standard features of the 8881

### **8880 Product Features:**

- Block Frame
- White Paint, Mojave Beige Paint, Clear Anodized and Bronze Anodized
- 1" O.A. Glass Package
- Standard Low-E or upgrade to Low-E Extreme
- 1 13/16" Rollers
- Stainless Steel Rollers available
- Attractive "C" Handle
- Surface Mount Sill
- Screens Optional

### **8881 Product Features:**

- Block Frame
- White Paint, Mojave Beige Paint, Clear Anodized and Bronze Anodized
- 1" O.A. Glass Package
- Standard Low-E or upgrade to Low-E Extreme
- QUAD Door Roller System
- Flush Pull Handle - Available in brushed nickel finish
- Surface Mount Sill
- Screens Optional

## 8880 and 8881 Ambassador Multi-Slide Doors

Designers and Architects love the thermal values that the 8880 and 8881 provide, while homeowners embrace the slim lines that afford them the beautiful views of their world. IWC has designed a product that is truly your "Window to the World".

Whether your view is of the ocean, the desert, or the mountains, you'll view it beautifully through the Ambassador Multi-Slide. A true luxury door that affords you the ability to enjoy your views while helping to keep you cozy in the winter and more comfortable in the summer.



**Flush Pull Handle - View from inside**



**Flush Pull Handle - View from outside**



## LIFETIME WARRANTY\*

International Window (IWC) warrants its window and door products to be free from defects in material or workmanship that significantly impair their proper operation for the lifetime of your home for as long as you own it.

**Coverage:**

The lifetime coverage of this warranty applies to original owners of single-family homes and owners of single-family homes who purchase IWC products for remodeling or replacement. Proof of purchase and of continuous ownership will be required.

\*For commercial buildings, multi-family dwellings, apartments and other types of buildings, the warranty period shall be ten (10) years following the date of purchase.

\*For Jalousie products, the warranty period shall be ten (10) years following the date of purchase.

**Coverage for Glass Breakage:**

For Gentry 5400 Series products only, the Lifetime Warranty will extend to glass breakage, including tempered glass, unless attributable to acts of nature, (e.g. hurricane, fire, etc.) building settling, vandalism, civil disorder, structural failures of walls or foundation or improper installation, storage, applied films or handling. Specialty glass such as Laminated, V-Groove, etc. are not covered under this glass breakage warranty. This glass breakage warranty applies to products sold after October 1, 2015.

**Limitations:**

This warranty is limited, may not be assigned or transferred and does not include component failure due to improper installation, application or use, abuse, abnormal stresses due to vibration, heat and settlement, or acts of God. IWC is not liable for natural weathering of exterior finishes or for corrosion in highly corrosive environments. All glass warranties are void if any sun control film is applied to the glass surface. Insulating unit seal failure resulting from glass breakage is also not covered.

**Remedy:**

IWC will, at its sole discretion, repair or replace free of charge, including parts and labor, any window or door proven to be defective in material or workmanship during the applicable warranty period. If IWC is unable to provide replacement, or if repair is not commercially practical, IWC will refund the original purchase price.

**Claims:**

To claim service under this warranty, the homeowner shall provide written notification of the defect along with dated proof of purchase and proof of original home ownership to your nearest IWC facility or authorized IWC dealer. IWC reserves the right to conduct an on-site inspection of defective products in place and as originally installed.

**Other Conditions:**

THIS WARRANTY IS EXPRESSLY IN LIEU OF ALL OTHER ORAL OR WRITTEN WARRANTIES, LIABILITIES OR OBLIGATIONS. IN NO EVENT SHALL IWC BE LIABLE FOR CONSEQUENTIAL OR INCIDENTAL DAMAGES OF ANY KIND, INCLUDING ANY DAMAGE TO THE BUILDING, ITS CONTENTS OR ANY PERSON THEREIN, RESULTING FROM THE BREACH OF ANY WARRANTY SET FORTH HEREIN. SOME STATES DO NOT ALLOW LIMITATIONS ON OR THE EXCLUSION OF INCIDENTAL OR CONSEQUENTIAL DAMAGES, SO THE ABOVE EXCLUSIONS MAY NOT APPLY TO YOU!

This limited warranty gives you specific legal rights, and you may also have other rights that vary from state to state.

This warranty applies to products sold after July 1, 2011.

**International Window - Northern California: 1.800.624.0990**  
**International Window - Southern California: 1.800.477.4032**



### INTERNATIONAL WINDOW

Northern California  
1.800.624.0990

Southern California  
1.800.477.4032

Visit our website at [www.intlwindow.com](http://www.intlwindow.com)

